

**Additional parts required:**

- › Ballast 10 kg, order no. 0050879
- › Ballast 15 kg, order no. 0050985
- › Wall connector, order no. 707241

## 7070 Mobile tower ADVANCED SAFE-T complying with EN 1004

Frame section width	0.72 m
Platform length	1.58 m
Reach height	3.25 – 11.25 m
Tower height	2.47 – 10.34 m
Standing height	1.25 – 9.25 m

- › Mobile tower with safe assembly concept.
- › Secure standing in every phase of assembly and dismantling.
- › With four stabilisers as standard from a reach height of 4.25 m.
- › With a reach height of 7.25 m or more additionally supplied with telescopic stabiliser extensions which can be fitted from floor level thanks to the bayonet catch.
- › Welded frame sections are robust and improve the stability of the tower, meaning that greater assembly heights can be achieved.
- › With height-adjustable, spindle mounted castors and are thus suited for all work, both interior and exterior.
- › **Permissible load:** 200 kg/m<sup>2</sup> (2,0 kN/m<sup>2</sup>), according to tower group 3, DIN EN 1004.

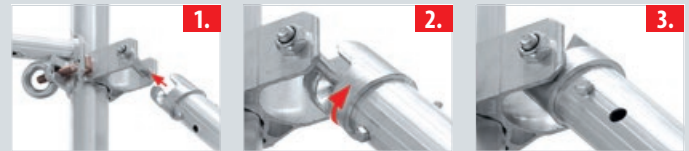
**From module 3 with bayonet stabiliser**

It is so quick and easy to twist the bayonet stabiliser into the bayonet coupling on the frame part and this can be assembled from the ground.



In addition the bayonet stabiliser can be telescoped to adapt to all ground surfaces.

**Note:**

**Every tower is accompanied by instruction manual for assembly and use.**

**The required number of additional parts for fastening to the wall or ballasting may be found in the ballasting tables in the catalogue.**

Ballasting 7070					
Order no.		kg	kg	kg	kg
707003	Modules 1	0	0	0	0
707004	Modules 1+KIT+stabilisers	0	80**	0	110**
707005	Modules 1+2	0	80**	0	110**
707006	Modules 1+2+KIT	0	140**	40**	210**
707007	Modules 1+2+3	0	120**	0	240**
707008	Modules 1+2+3+KIT	40**	180**	80**	0 <sup>2)</sup>
707009	Modules 1+2+3+4	40**	180**	80**	0 <sup>2)</sup>
707010	Modules 1+2+3+4+KIT	60**	240**	not permissible	not permissible
707011	Modules 1+2+3+4+4	60**	240**	not permissible	not permissible

\*\* With the use of two wall connectors 707241 no ballasting necessary.

Additional parts required:

<sup>2)</sup> plus 2 wall connectors, order no. 707241

## 7070 Assembling combinations with stabilisers

- › Stable, welded 8 rung frame sections
- › Height-adjustable castors
- › Frame section width 0.72 m
- › Platform length 1.58 m

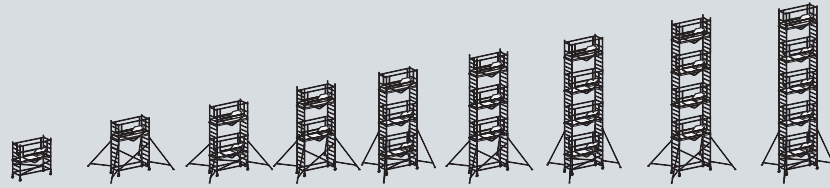

Assembling combinations		Module 1	Module 1+KIT+Ausleger	Module 1+2	Module 1+2+KIT	Module 1+2+3	Module 1+2+3+KIT	Module 1+2+3+4	Module 1+2+3+4+KIT	Module 1+2+3+4+4	Length approx. m	Width approx. m	Weight approx. kg
Order no.	Description	707003	707004	707005	707006	707007	707008	707009	707010	707011			
	Reach height approx. m	3.25	4.25	5.25	6.25	7.25	8.25	9.25	10.25	11.25			
	Tower height approx. m	2.47	3.47	4.34	5.34	6.34	7.34	8.34	9.34	10.34			
	Standing height approx. m	1.25	2.25	3.25	4.25	5.25	6.25	7.25	8.25	9.25			
<b>Individual elements/list of components</b>													
707022	8 rung frame section	2	2	4	4	6	6	8	8	10	2.15	0.72	8.2
707023	4 rung frame section	–	2	–	2	–	2	–	2	–	1.15	0.72	4.6
7089424	Platform with trapdoor	1	1	2	2	3	3	4	4	5	1.58	0.61	7.6
709029	Safety guardrail short	2	2	4	4	6	6	8	8	10	1.59		3.2
7090127	Diagonal brace	2	2	2	2	2	2	2	2	2	1.67		1.0
7089427	Diagonal brace	–	2	–	2	–	2	–	2	–	2.04		1.2
7089428	Brace	2	2	2	2	2	2	2	2	2	1.59		0.8
707035	Base section stabiliser	–	4	4	4	4	4	4	4	4	2.55	0.15	4.9
707037	Stabiliser extension section	–	–	–	–	4	4	4	4	4	1.14	0.15	1.6
7009425	Toeboard long side <sup>1)</sup>	–	–	2	2	2	2	2	2	2	1.53	0.17	1.8
707226	Toeboard front side <sup>1)</sup>	–	–	2	2	2	2	2	2	2	0.66	0.15	0.8
707044	Entrance bracket	–	–	1	1	1	1	1	1	1	0.56	0.45	1.2
007503	Castor Ø 150 mm with spindle	4	4	4	4	4	4	4	4	4			4.0
007760	Safety plug	–	4	4	8	8	12	12	16	16			0.1
0095689	Assembly instructions	1	1	1	1	1	1	1	1	1			
<b>Total weight approx. kg</b>		<b>50.0</b>	<b>81.6</b>	<b>106.8</b>	<b>118.8</b>	<b>144.0</b>	<b>156.0</b>	<b>174.8</b>	<b>186.8</b>	<b>205.6</b>			

According to EN 1004, standing heights of 8 m and more are permissible only in the interior.

## 7070 Single modules



Individual elements/list of components		Module 1	Module 2	Module 3	Module 4	KIT	Set of stabilisers	Length approx. m	Width approx. m	Weight approx. kg
Order no.	Description	707003	707015	707017	707019	707001	707002			
707022	8 rung frame section	2	2	2	2	–	–	2.15	0.72	8.2
707023	4 rung frame section	–	–	–	–	2	–	1.15	0.72	4.6
7089424	Platform with trapdoor	1	1	1	1	–	–	1.58	0.61	7.6
709029	Safety guardrail short	2	2	2	2	–	–	1.59		3.2
7090127	Diagonal brace	2	–	–	–	–	–	1.67		1.0
7089427	Diagonal brace	–	–	–	–	2	–	2.04		1.2
7089428	Brace	2	–	–	–	–	–	1.59		0.8
707035	Base section stabiliser	–	4	–	–	–	4	2.55	0.15	4.9
707037	Stabiliser extension section	–	–	4	–	–	–	1.14	0.15	1.6
7009425	Toeboard long side <sup>1)</sup>	–	2	–	–	–	–	1.53	0.17	1.8
707226	Toeboard front side <sup>1)</sup>	–	2	–	–	–	–	0.66	0.15	0.8
707044	Entrance bracket	–	1	–	–	–	–	0.56	0.45	1.2
007503	Castor Ø 150 mm with spindle	4	–	–	–	–	–			4.0
007760	Safety plug	–	4	4	4	4	–			0.1
0095689	Assembly instructions	1	1	1	1	1	–			
<b>Total weight approx. kg</b>		<b>50.0</b>	<b>56.8</b>	<b>37.2</b>	<b>30.8</b>	<b>12.0</b>	<b>19.6</b>			

<sup>1)</sup> Possible accessory element: Toeboard folding, order no. 707025, see on page 129.